

SMD Aluminum Electrolytic Capacitor – JCA

FEATURES

- Life time 105°C 6000hrs standard product
- High stability and reliability
- Reflow soldering is available
- Available for high density surface mounting



SPECIFICATIONS

Category Temperature Range
 Rated Voltage Range
 Capacitance Range
 Capacitance Tolerance
 Leakage Current
 Dissipation Factor (MAX)
 Tan δ (20°C, 120Hz)

-40°C ~ +105°C
 160V ~ 450V.DC
 1 ~ 22μF
 ±20% (120Hz, 20°C)
 $I = 0.04CV (\mu A) + 100 (\mu A)$ after 2 minutes
 $I =$ Leakage Current (μA) $C =$ Nominal Capacitance (μF) $V =$ Rated Voltage (V)

Rated Voltage (V)	160 ~ 200	250 ~ 400	450
Tan δ	0.20	0.25	0.30

In 105°C degrees Celsius environment, continuous application of rated voltage for 6000 hours, after 16 hours was measured at room temperature, the capacitors shall meet the following requirements :

Load Life

Capacitance Change	Within ± 30% of the initial value
Dissipation Factor	Not more than 300% of the specified value
Leakage Current	Not more than the specified value

After storage for 1000hrs at 105°C, then resumed 16 hours, the capacitors shall meet the following requirements

Shelf Life

Capacitance Change	Within ± 30% of the initial value
Dissipation Factor	Not more than 300% of the specified value
Leakage Current	Within 300% of initial specified value

The capacitors shall be kept on then hot plate maintained at 250°C for 30 seconds. After removing from the hot plate and restored at room temperature, they meet the following requirement:

Resistance to Soldering Heat

Capacitance Change	Within ± 10% of initial value
Dissipation Factor	Not more than the initial specified value
Leakage Current	Not more than the initial specified value

Low Temperature Stability Impedance Ratio (MAX) 120Hz

Rated Voltage (V)	160 ~ 200	250 ~ 400	450
Z-25°C / Z+20°C	6	10	12
Z-55°C / Z+20°C	8	12	15

DRAWING (Unit: mm)

Fig. 1 (Φ6.3 ~ Φ10)

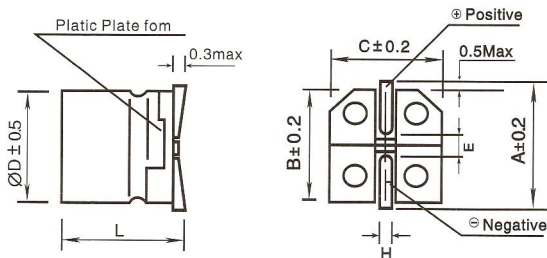
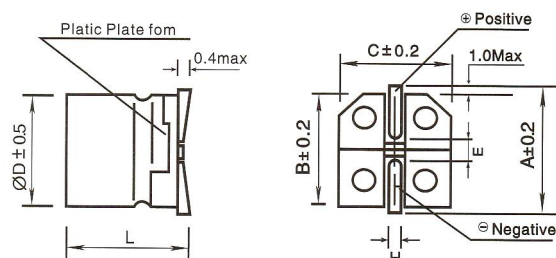

Fig. 2 (≥Φ12.5)



ΦD	L	A	B	C	E	H	Fig. No.
6.3	10.2 ± 0.3	7.2	6.6	6.6	2.1	0.5 ~ 0.9	1
8	10.2 ± 0.5	9.1	8.3	8.3	3.1	0.8 ~ 1.1	1
8	12.5 ± 0.5	9.1	8.3	8.3	3.1	0.8 ~ 1.1	1
10	10.2 ± 0.5	11.1	10.3	10.3	4.5	0.8 ~ 1.1	1
10	12.5 ± 0.5	11.1	10.3	10.3	4.5	0.8 ~ 1.1	1
12.5	13.5 ± 0.5	13.7	13.0	13.0	4.4	1.0 ~ 1.4	2

Please visit our website to get more update data, those data & specification are subject to change without notice.

SMD Aluminum Electrolytic Capacitor – JCA

FREQUENCY COEFFICIENT

Frequency	120Hz	1kHz	10kHz	100kHz
Coefficient	1.00	1.25	1.40	1.60

STANDARD SIZE

WV	160			200			250			400			450		
	DxL	Tan δ	mA	DxL	Tan δ	mA	DxL	Tan δ	mA	DxL	Tan δ	mA	DxL	Tan δ	mA
1	--	--	--	--	--	--	6.3x10.2	0.25	10	6.3x10.2	0.25	9	8x10.2	0.30	15
1.5	--	--	--	--	--	--	6.3x10.2	0.25	14	6.3x10.2	0.25	11	8x10.2	0.30	18
2.2	--	--	--	--	--	--	6.3x10.2	0.25	16	6.3x10.2	0.25	13	8x10.2	0.30	20
										8x10.2	0.25	15			
3.3	--	--	--	--	--	--	6.3x10.2	0.25	18	8x10.2	0.25	20	10x10.2	0.30	25
							8x10.2	0.25	21						
4.7	--	--	--	8x10.2	0.20	25	8x10.2	0.25	26	8x12.5	0.25	33	10x12.5	0.30	39
										10x10.2	0.25	35			
5.6	--	--	--	8x10.2	0.20	27	8x10.2	0.25	28	10x12.5	0.25	43	10x12.5	0.30	48
6.8	6.3x10.2	0.20	26	8x10.2	0.20	30	10x10.2	0.25	34	10x12.5	0.25	48	10x12.5	0.30	53
	8x10.2	0.20	30												
8.2	8x10.2	0.20	35	8x10.2	0.20	33	10x10.2	0.25	37	12.5x13.5	0.25	62	--	--	--
10	8x10.2	0.20	43	10x10.2	0.20	40	10x10.2	0.25	45	12.5x13.5	0.25	69	--	--	--
	10x10.2	0.20	50												
12	10x10.2	0.20	53	10x10.2	0.20	45	10x10.2	0.25	50	--	--	--	--	--	--
15	10x10.2	0.20	55	10x12.5	0.20	58	10x12.5	0.25	67	--	--	--	--	--	--
22	10x12.5	0.20	63	--	--	--	--	--	--	--	--	--	--	--	--

Rated ripple current (mA, 105°C, 120Hz)

Please visit our website to get more update data, those data & specification are subject to change without notice.